

**Fleet Feet Blue Dome #2
Quarter Marathon (10.55K)
Tulsa, OK**

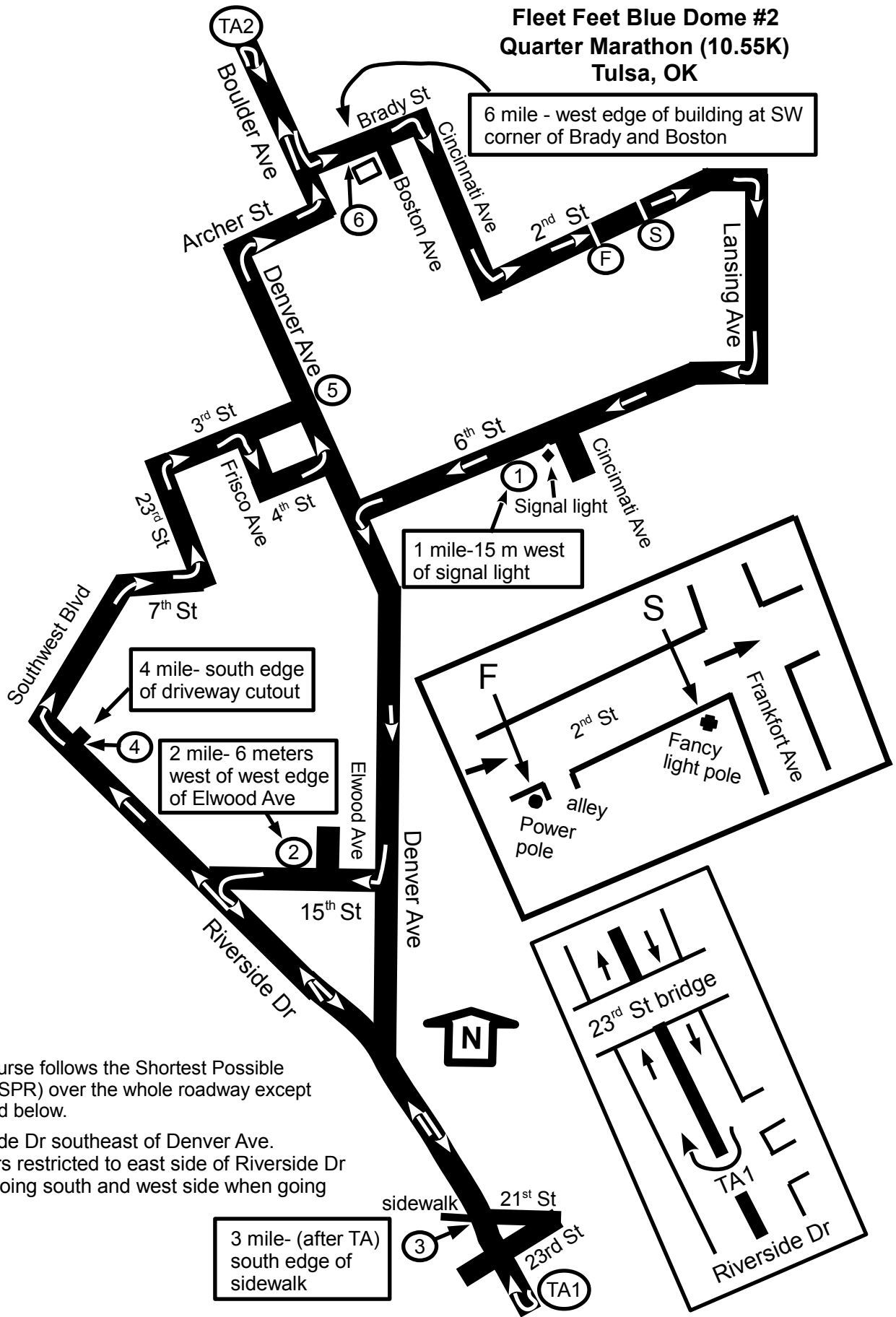

This course follows the Shortest Possible Route (SPR) over the whole roadway except as noted below.

Riverside Dr southeast of Denver Ave.
Runners restricted to east side of Riverside Dr when going south and west side when going north

3 mile- (after TA) south edge of sidewalk

Fleet Feet Blue Dome
5K
Tulsa, OK

USATF Certification
 OK13064DG

Effective
 08-16-13 to 12-31-23

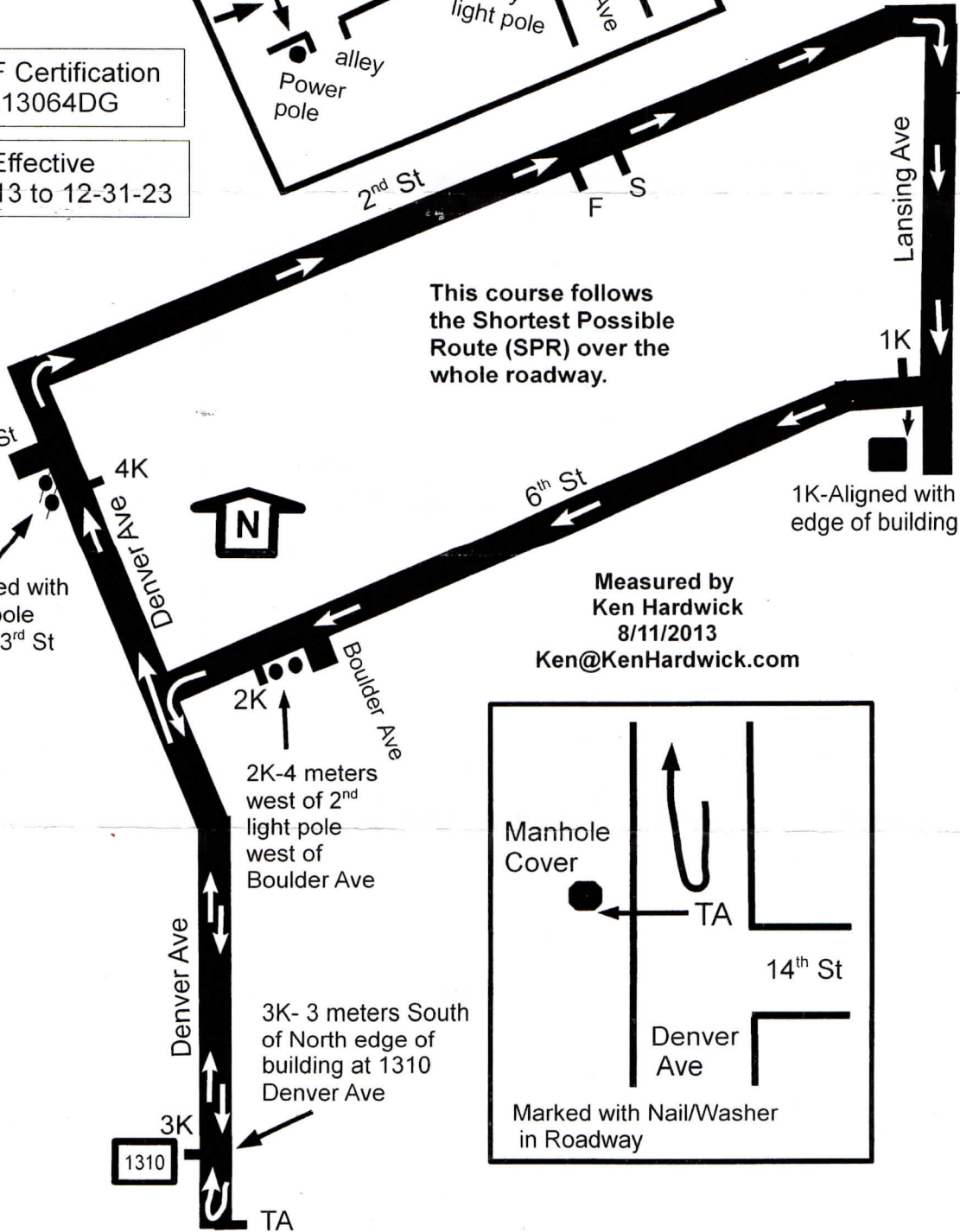
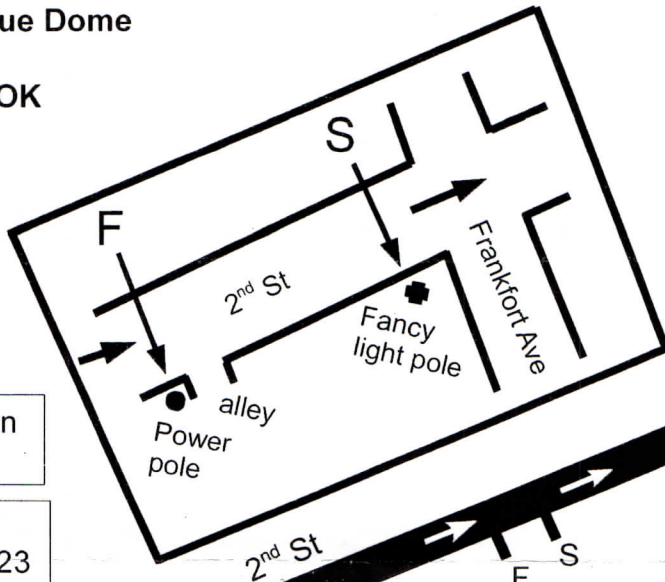

This course follows
 the Shortest Possible
 Route (SPR) over the
 whole roadway.

1K-Aligned with east
 edge of building

4K-Aligned with
 2nd light pole
 South of 3rd St

2K-4 meters
 west of 2nd
 light pole
 west of
 Boulder Ave

3K- 3 meters South
 of North edge of
 building at 1310
 Denver Ave

Measured by
 Ken Hardwick
 8/11/2013
 Ken@KenHardwick.com

